



Colt



# Highland RIDGE RV

Serial #: 58TBM0BP8T16X3250  
Model: 26DBS COLT TT

Model Year: 2026 Dealer Name: BERRYLAND CAMPERS  
42775 PLEASANT RIDGE ROAD  
PONCHATOULA, LA 70454  
USA

**Manufacturer's Suggested Retail Price \$39,039.00**

TOTAL AMOUNT DOES NOT INCLUDE STATE AND LOCAL TAXES OR LICENSE FEES. THE PRICE SHOWN ABOVE MAY OR MAY NOT BE REPRESENTATIVE OF THE ACTUAL SELLING PRICE OF SIMILAR RECREATIONAL VEHICLES IN YOUR AREA.

### Standard Equipment

THE FOLLOWING ITEMS ARE STANDARD ON THIS MODEL

**STANDARD EXTERIOR EQUIPMENT**  
30 amp service  
8,000 BTU wall mount A/C (single axle models)  
Axles with easy-lube hubs  
Built-in A-Frame  
Coax cable TV jack  
ForTruss Rafter system  
Galvanized wheel wells  
Large exterior downspouts  
LP quick connect (via CTR edition)  
Nitrogen filled radial tires  
PVC roofing membrane (limited lifetime warranty)  
Self-adjusting electric brakes

**CUSTOMER CONVENIENCE PACKAGE**  
8 cu. ft. 12V refrigerator  
Bathroom skylight  
Bathroom vent  
Detachable power cord  
Entry door with window and shade prep  
Fitted bed sheet  
G20 dark tinted privacy windows  
Large folding entry door grab handle  
LED interior and exterior lights  
Microwave oven  
On demand tankless water heater  
Power awning  
Range Hood  
Rear camera prep  
Spare tire  
Stabilizer jacks  
Swing down solid main entry steps  
Tub/shower surround  
Window shades

**STANDARD INTERIOR EQUIPMENT**  
300 lb. rated single bunk beds  
600 lb. rated double bunk beds  
Dome style TV antenna  
Foot flush marine-grade toilet  
Full extension, heavy-duty, ball-bearing drawer guides with 75 lb. Rating  
Plywood bed platforms  
Queen mattress  
Residential grade kitchen countertops  
Residential-style hidden cabinet door hinges  
Residential-style high rise kitchen faucet  
Shower curtain with curved shower track (certain models)  
Solid hardwood cabinet doors with screwed stile construction and hidden hinges  
Vanity mirror with wood trim  
Vinyl flooring throughout

### Optional Equipment

OPTIONAL EQUIPMENT INSTALLED ON THIS VEHICLE BY MANUFACTURER

Base price	32,528.00
USA STANDARDS	n/c
CUSTOMER CONVENIENCE PACKAGE	4,875.00
NO AUTUMN RIDGE PACKAGE	n/c
NO SELECT PACKAGE	n/c
15,000 BTU ROOF MOUNTED AC	300.00
2ND AC	893.00
50 AMP SERVICE	443.00
METAL SIDEWALL	n/c
BLACK SPOKE RIMS	n/c
JACK KNIFE SOFA	n/c

UNIT TOTAL **39,039.00**

DEALER INSTALLED OPTIONS

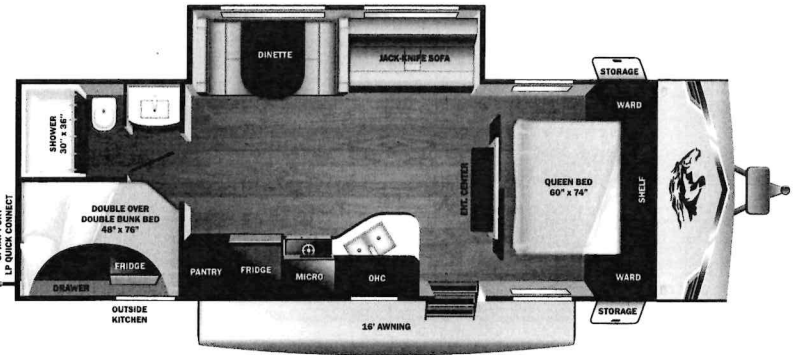

**UVW**  
6040 lbs

**Sleeps**

**Length**  
30' 3.63"

#### DIMENSIONS

Exterior height:.....132.75"  
Exterior width:.....96.00"

#### WEIGHTS

GVWR:.....7600  
GAWR (front):.....3500  
GAWR (rear):.....3500  
Approx. Gross Cargo Carrying Capacity(GCCC):.....1560

#### CAPACITIES

Fresh water tank (gals.):...52.00  
Gray water tank (gals.):...39.00  
Black water/toilet tank (gals.):...39.00  
Propane (lbs.):.....40  
Propane (gals.):.....9  
Water heater (gals.):.....0.25

#### SEATING & SLEEPING

#### TIRES

Tire size (front):.....ST205/75R14D  
Tire size (mid):.....  
Tire size (rear):.....ST205/75R14D

\*\*\*Some dimensions may be rounded and may vary from the actual dimensions\*\*\*  
\*\*\*Weights may be estimated calculations and may vary from the actual weight - refer to the vehicle weight labels for actual weights\*\*\*  
Floorplans, features and specifications are subject to change without notice.

