



# Highland

## RIDGE RV

### Open Range 3X



Serial #: 58TCM0BV4T1B63077  
Model: 390TBS OPEN RANGE 3X FW

Model Year: 2026 Dealer Name: BERRYLAND CAMPERS  
42775 PLEASANT RIDGE ROAD  
PONCHATOULA, LA 70454  
USA

#### Standard Equipment

THE FOLLOWING ITEMS ARE STANDARD ON THIS MODEL

**STANDARD EXTERIOR EQUIPMENT**  
60K BTU on demand hot water heater  
102" wide body frame  
2" Receiver hitch (r/a 390TBS)  
2-40 lb. LP bottles  
4000 MORryde® Suspension  
50 amp service  
ACCU-SLIDE™ slide system (42" deep 4-corner compression)  
Battery disconnect switch  
Brass hanger bushings with wet bolts  
Equa-Flex® axle suspension  
Exterior grill/griddle quick connect port  
H rated steel belted radial tires  
Integrated aluminum hub rims  
Laminated block foam floor  
LevelLoc™ - 4 or 6 point automatic leveling with JT's  
Strong Arms®  
PVC roofing membrane (limited lifetime warranty)  
Rear roof access ladder  
Self-adjusting electric brakes  
Spare tire  
Square frameless windows  
TuffShell™ - vacuum bonded laminated construction, reinforced with heavy-duty fiberglass and welded aluminum frames  
Xtend Solar I Package (1-200 watt solar panel with 30 amp controller)

**FOUR SEASON PACKAGE**  
2.625" sidewall, 50% thicker wall with 3/4" vapor barrier between the interior and the aluminum tubes  
40K BTU high performance furnace  
5K BTU electric fireplace  
Double insulated baggage doors  
Ducted heat to underbelly with cold air return  
Enclosed exterior docking station with black tank flush  
Heated and enclosed underbelly  
R-17 block foam insulation in sidewalls with 3/4" vapor barrier  
R-38 reflective foil insulation in ceiling and underbelly

**STANDARD INTERIOR EQUIPMENT**  
72" x 78" Residential king bed with power base  
75 lb. ball bearing drawer guides  
9" 3 layer firm/soft option residential mattress  
Cable and satellite prep  
Central vacuum  
Ceramic subway tile backsplash  
Fiberglass shower base  
Flip down night stands on bed slideout fascia  
Flexible reading lights with USB chargers  
Flush floor slides with residential vinyl flooring  
GE® 21 cu. ft. residential refrigerator  
GE® 3.75 cu. ft. freestanding oven and 4-burner range  
GE® 30" OTR residential microwave  
Glass shower door  
Hardwood ceiling soffit  
Hardwood slideout fascia  
Large hidden pantry  
LED interior lighting  
Polychild screen guard on screen door  
Porcelain lavatory bowl with single lever faucet  
Rainfall kitchen sink with produce and glass rinser  
Raised panel hardwood cabinet doors  
Screen shot (automatic screen door closer)  
Solid surface lavatory top  
Solid surface waterfall island  
Square windows with intergraded blinds  
Table and 4 chairs  
Theater seating with power recline  
Wall controlled power vent (kitchen/living room area)  
Washer/dryer prep

**EXECUTIVE PACKAGE**  
3-15,000 BTU A/C with quiet residential return air  
Cutting board and sink strainer  
Dome style digital TV antenna with Wi-Fi prep  
Interior convenience center light  
Keyed-Alike® entry and baggage doors  
Main bedroom TV - 32"  
Motion sensor lighting in bedroom and hallway  
Painted fiberglass front cap with LED lighting  
Power awning with LED lighting  
Quick recovery gas/electric water heater  
Quick release fresh water drain  
Residential high-rise faucet with pull-down sprayer  
Security camera prep above entrance door  
Single basin stainless steel under-mount kitchen sink  
Smart entertainment HDTV with Bluetooth®, soundbar and built in stereo  
Solid swing-down entry steps  
Solid-surface kitchen countertops  
Stainless steel appliances  
TravelINK® - smart RV system that allows for Bluetooth® control of awnings, lighting, slideouts, heating, cooling and more  
USB/12V charging port

#### Optional Equipment

OPTIONAL EQUIPMENT INSTALLED ON THIS VEHICLE BY MANUFACTURER

Base price 120,855.00  
USA STANDARDS n/c  
EXECUTIVE PACKAGE 6,000.00  
FOUR SEASONS PROTECTION PACKAGE 750.00  
XTEND SOLAR II PACKAGE 1,343.00  
HEAT PUMP ON MAIN AC 375.00  
POWER FAN VENT WALL CONTROL BATHROOM 375.00  
21 CU. FT. 110 VOLT REFRIGERATOR n/c  
DISHWASHER 1,013.00  
NO GENERATOR PREP n/c  
WINDOWS STANDARD n/c  
NO PIN BOX n/c

UNIT TOTAL 130,711.00

DEALER INSTALLED OPTIONS

### Manufacturer's Suggested Retail Price \$130,711.00

TOTAL AMOUNT DOES NOT INCLUDE STATE AND LOCAL TAXES OR LICENSE FEES. THE PRICE SHOWN ABOVE MAY OR MAY NOT BE REPRESENTATIVE OF THE ACTUAL SELLING PRICE OF SIMILAR RECREATIONAL VEHICLES IN YOUR AREA.

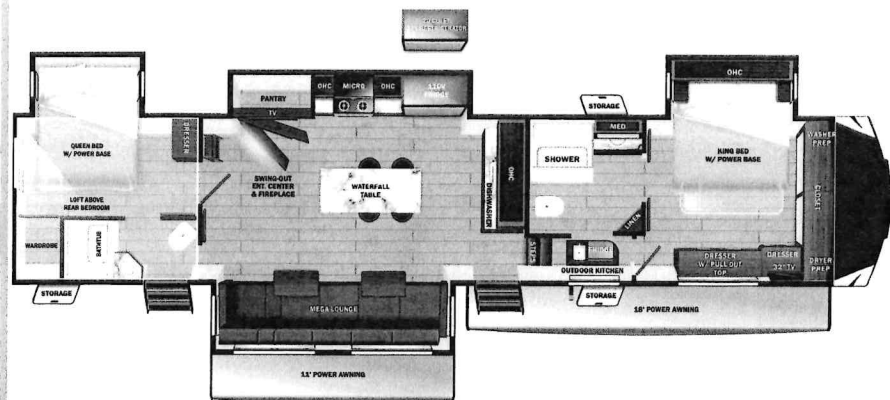

**lb** **UVW**  
14839 lbs

**Sleeps**

**Length**  
43' 7.13"

#### DIMENSIONS

Exterior height:.....154.50"  
Exterior width:.....101.75"

#### WEIGHTS

GVWR:.....16995  
GAWR (front):.....7000  
GAWR (rear):.....7000  
Approx. Gross Cargo Carrying Capacity (GCCC):.....2156

#### TIRES

Tire size (front):.....  
Tire size (mid):.....  
Tire size (rear):.....

#### CAPACITIES

Fresh water tank (gals.):...75.00  
Gray water tank (gals.):...97.00  
Black water/toilet tank (gals.):...80.00  
Propane (lbs.):...80  
Propane (gals.):...18  
Water heater (gals.):...0.25

#### SEATING & SLEEPING

\*\*\*Some dimensions may be rounded and may vary from the actual dimensions\*\*\*

\*\*\*Weights may be estimated calculations and may vary from the actual weight

- refer to the vehicle weight labels for actual weights\*\*\*

Floorplans, features and specifications are subject to change without notice.

**3**  
**YEAR**  
LIMITED  
STRUCTURAL  
WARRANTY