



Open Range Light



Serial #: 58TBM0BR5S3TL3087
Model: 275RLS OPEN RANGE LIGHT TT

Model Year: 2025 Dealer Name: BERRYLAND CAMPERS
42775 PLEASANT RIDGE ROAD
PONCHATOULA, LA 70454
USA

Standard Equipment

THE FOLLOWING ITEMS ARE STANDARD ON THIS MODEL

EXTERIOR

- 120 GFCI protected receptacle
- 5/8" main floor decking
- Class leading I-beam chassis and draw bar sizes
- Enclosed exterior docking station with black tank flush
- Equa-Flex® axle suspension
- Exterior grill/griddle quick connect port
- Fully walkable roof
- Gas/electric water heater
- In-frame battery rack
- Large grab handle on main entry door
- Magnetic baggage door catches
- Nitrogen filled radial tires with aluminum rims
- Power awning with LED lighting
- Power tongue jack
- PVC roofing membrane (limited lifetime warranty)
- Rain guttering with molded drip spouts
- Rear observation camera prep
- Self-adjusting electric brakes
- Side marker light camera prep
- Thermal Seal- enclosed, insulated and heated underbelly and fully insulated roof with a PVC roofing membrane
- TuffShell™ - vacuum bonded laminated construction, reinforced with heavy-duty fiberglass and welded aluminum frames
- Xtend Solar I Package (200 watt solar panel with 30 amp solar controller)

INTERIOR

- 10 cu. ft. 12V refrigerator
- 15,000 BTU roof mounted A/C
- 50 amp service with 2nd A/C prep
- 5G antenna
- 75 lb. ball bearing drawer guides
- Cable and satellite prep
- Dome style digital TV antenna with Wi-Fi prep
- Electrical outlets and USB ports in master bedroom
- Flush floor slides with residential vinyl flooring
- Glass shower doors
- Hardwood cabinet doors
- Hidden hinge cabinet door hinges
- Kitchen sink covers
- LED interior lighting
- Magnetic cabinet door catches
- Microwave
- Pressed membrane countertops
- Range hood vented outside
- Residential high-rise faucet
- Roller blackout night shades
- Stainless steel single basin under-mount kitchen sink

CUSTOMER CONVENIENCE PACKAGE (Mandatory)

- 3-burner range with 17" oven and flush mount glass cover
- 72" x 80" residential style king bed
- Keyed-Alike™ entry and baggage doors
- Molded front cap with LED lighting and stoneguard protection
- Pop up wireless and USB charger in bedroom
- Smart Entertainment HDTV with Bluetooth®, Soundbar and Built in Stereo
- TravelINK® - Smart RV system that allows for Bluetooth® control of awnings, lighting, slideouts, heating, cooling and more

Optional Equipment

OPTIONAL EQUIPMENT INSTALLED ON THIS VEHICLE BY MANUFACTURER

Base price	58,832.00
USA STANDARDS	n/c
CUSTOMER CONVENIENCE PACKAGE	4,875.00
XTEND SOLAR I PACKAGE	n/c
2ND AC	1,043.00
STABILIZER JACKS	893.00
THEATER SEATS W/TABLE TRAY	n/c
FREE STANDING TABLE WITH CHAIRS	413.00
TRI-FOLD SOFA	n/c

UNIT TOTAL 66,056.00

DEALER INSTALLED OPTIONS

Manufacturer's Suggested Retail Price \$66,056.00

TOTAL AMOUNT DOES NOT INCLUDE STATE AND LOCAL TAXES OR LICENSE FEES. THE PRICE SHOWN ABOVE MAY OR MAY NOT BE REPRESENTATIVE OF THE ACTUAL SELLING PRICE OF SIMILAR RECREATIONAL VEHICLES IN YOUR AREA.

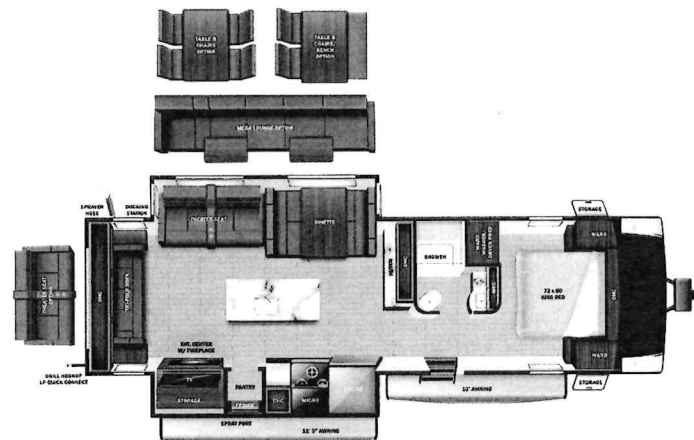

UVW
7602 lbs



Sleeps



Length
33' 10.88"

DIMENSIONS

Exterior height:.....134.38"
Exterior width:.....96.63"

WEIGHTS

GVWR:.....8995
GAWR (front):.....4400
GAWR (rear):.....4400
Approx. Gross Cargo Carrying Capacity(GCCC):.....1393

CAPACITIES

Fresh water tank (gals.):...45.00
Gray water tank (gals.):...58.00
Black water/toilet tank (gals.):.....29.00
Propane (lbs.):.....60
Propane (gals.):.....14
Water heater (gals.):.....6.00

SEATING & SLEEPING

TIRES

Tire size (front):.....ST225/75R15E
Tire size (mid):.....
Tire size (rear):.....ST225/75R15E

Some dimensions may be rounded and may vary from the actual dimensions

Weights may be estimated calculations and may vary from the actual weight - refer to the vehicle weight labels for actual weights

Floorplans, features and specifications are subject to change without notice.

