

Pre-owned Motorhome Data Sheet

Classification: Class A _____ Class B _____ Class C

Powertrain: Gasoline Diesel _____

Horsepower: 300 _____ 340 _____ 350 _____ 360 _____ 380 _____ 400 _____
450 _____ 500 _____ 600 _____ 625 _____ Other

Chassis: Ford _____ Chevy Workhorse _____ Dodge _____ Mercedes _____
Spartan _____ Freightliner _____ Powerglide _____ Roadmaster _____ Other _____

Generator Brand: Onan Generac _____ Powertec _____

Generator KW Size: 4K 5.5K _____ 6K _____ 7.5K _____ 8K _____ 10K _____
12.5K _____ Other _____

House Amperage: 30 Amp 50 Amp _____

Jacks: Yes _____ No **Auto-leveling:** Yes _____ No

Satellite: In-motion _____ Stationary _____ None

Washer/Dryer: Stackable _____ Combination _____ None

Outside Entertainment: Yes _____ No

Sleeping Options: King _____ Queen Bunks _____ Overhead _____

Inverter: Yes _____ No

A/C's: 1 2 _____ 3 _____

Heat Pump: Yes _____ No

Bathroom Options: Single Bath and a half _____ 2 Baths _____

BERRYLAND CAMPERS
Jock Milton
Toll Free: 1.877.370.7001
Fax: 985.419.8445
Cell: 985.351.0885
jock@berrylandcampers.com
42775 Pleasant Ridge Rd. Ext
P.O. Box 266
Ponchatoula, LA 70454
I-12 Exit 42

⊕ STK # C016689

Salesman: Jock Milton

3 Hours

1,750 Miles

⊕ 2150 SUNSEEKER ⊕
FOREST RIVER

Forest River, Inc.

900 County Road 1
PO BOX 3030
Elkhart, IN 46515
USA

Sales ID S3365934

Vehicle Description

MAKE:	SUNSEEKER	SHIP TO ADDRESS:	BERRYLAND MOTORS LLC- PONCHATOULA, LA DBA BERRYLAND CAMPERS 42775 PLEASANT RIDGE ROAD PONCHATOULA, LA 70454 USA
MODEL:	SSC2150SLEC		
SERIAL NO.:	SSF063870		
VIN NO.:	1HA3GSC74PN016689		

Optional Equipment Installed By Manufacturer

RIVERTEAK-LAVA	RIVER TEAK-LAVA INTERIOR	1.00	\$0.00
34-6507-5	LE PREMIER PACKAGE BACK UP CAMERA/SIDE VIEW CAMERAS W/MONITOR, FIBERGLASS FRONT CAP, IN DASH PREMIUM SOUND SYSTEM W/BLUETOOTH, UNDERMOUNT 1.3 STAINLESS STEEL CONVECTION MICROWAVE, 10 CUFT 12V REFER, WINEGARD 360+ W/GATEWAY WIFI PREP, SLIDEROOM TOPPERS, ALUM RUNNING BOARDS, ARTIC PKG, 15K AC W/HEAT PUMP	1.00	\$1,818.60
1209-1	ROOF MOUNT SOLAR 12V CHARGING SYS. (INC. 2ND 12V BATTERY)	1.00	\$978.60
RVIA	RVIA SEAL	1.00	\$0.00
FREIGHT	FREIGHT CHARGES	1.00	\$1,577.00
TOLLS	TOLLS	1.00	\$34.00

WHEN NEW!!
😊

Base Price	Options	Suggested Retail
\$104,438.60	\$4,408.20	\$108,846.80

DO NOT REMOVE UNTIL SOLD

MANUFACTURER'S SUGGESTED RETAIL PRICE DOES NOT INCLUDE STATE AND LOCAL TAXES, DEALER PREP AND/OR OPTIONS INSTALLED BY DEALER. FOREST RIVER, INC. RESERVES THE RIGHT TO CHANGE PRICES AND SPECIFICATIONS WITHOUT NOTICE OR OBLIGATION.

SUNSEEKER

BY FOREST RIVER

LE



Scan here for available specs

STANDARD Exterior graphics
(Standard on LE, Classic, MBS & TS Models)

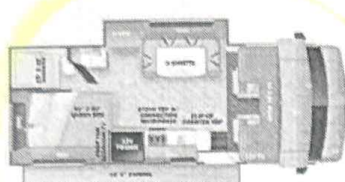

2150SLE (Available on Ford E350/Chevy 3500)



2250SLE (Available on Ford E350/Chevy 3500)

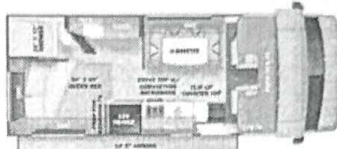

2350LE (Available on Ford E350/Chevy 3500)

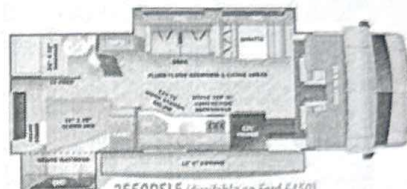

25500SLE (Available on Ford E450)

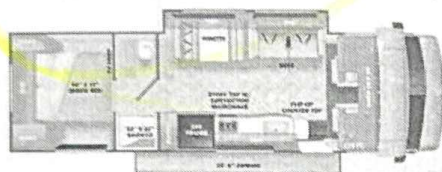

2850SLE (Available on Ford E450)

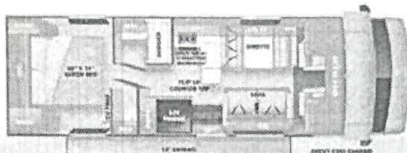

2950SLE (Available on Ford E450)

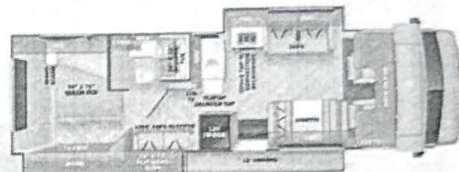

3250DSLE (Available on Ford E450)

CLASSIC

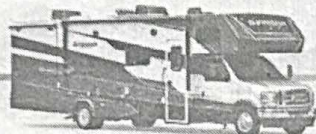

GARNET Full body paint

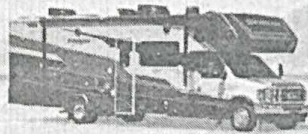

PACIFIC Full body paint



Scan here for available specs

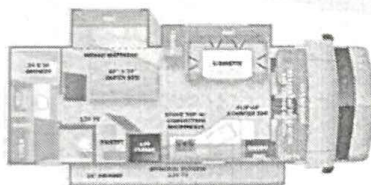

2440DS (Available on Ford E450)

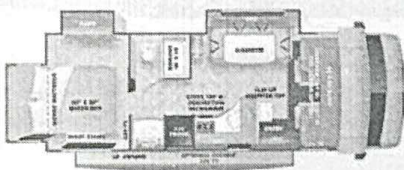

2500TS (Available on Ford E450)

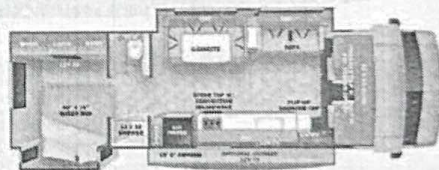

3010DS (Available on Ford E450)

OPTION



12V POWER
THEATER SEATING

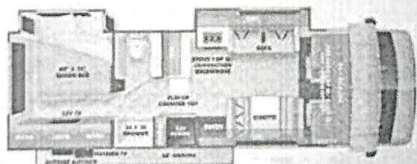

2860DS (Available on Ford E450)

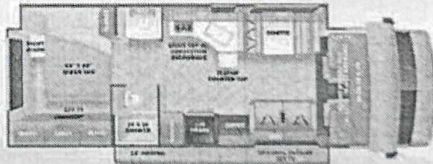

3050S (Available on Ford E450)

MBS



PLATINUM Full body paint
(also available on Transit)



ONYX Full body paint
(also available on Transit)

TS



Scan here for available specs

PM SERIES

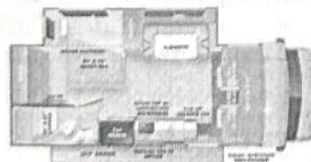

2400B (Available on Sprinter 3500)



Scan here for available specs



Mercedes-Benz

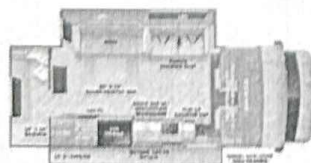

2400T (Available on Sprinter 3500)



TS2370 (Ford EcoBoost 3.5L gas engine)

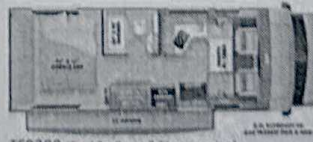

TS2380 (Ford EcoBoost 3.5L gas engine)



ALL-WHEEL
DRIVE
STANDARD

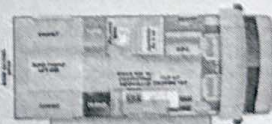

2030RP (Dodge ProMaster 3.6L V6 4WD)