



Highland RIDGE RV

Open Range Light



Serial #: 58TBM0BR8S3TL3066
Model: 275RLS OPEN RANGE LIGHT TT

Model Year: 2025 Dealer Name: BERRYLAND CAMPERS
42775 PLEASANT RIDGE ROAD
PONCHATOLA, LA 70454
USA

Manufacturer's Suggested Retail Price \$65,643.00

Standard Equipment

Optional Equipment

- EXTERIOR**
- 120 GFCI protected receptacle
 - 5/8" main floor decking
 - Class loading I-beam chassis and draw bar axles
 - Enclosed exterior docking station with black tank flush
 - Equalizer axle suspension
 - Exterior grill/door quick connect port
 - Fully washable roof
 - Gas/electric water heater
 - In-frame battery rack
 - Large grab handle on main entry door
 - Magnetic baggage door catches
 - Nitrogen filled radial tires with aluminum rims
 - Power awning with LED lighting
 - Power tongue jack
 - PVC roofing membrane (limited lifetime warranty)
 - Rash guttaring with molded drip spouts
 - Rear observation camera prep
 - Self-adjusting electric brakes
 - Side marker light camera prep
 - Thermal Seal- enclosed, insulated and heated underbody and fully insulated roof with a PVC roofing membrane
 - Turtleshield™ - vacuum bonded laminated construction, reinforced with heavy-duty fiberglass and welded aluminum frames
 - XTend Solar I Package (200 watt solar panel with 30 amp solar controller)

- INTERIOR**
- 10 cu ft 12V refrigerator
 - 15,000 BTU roof mounted A/C
 - 50 amp service with 2nd A/C prep
 - 50 antenna
 - 75 lb ball bearing drawer guides
 - Cable and satellite prep
 - Dome style digital TV antenna with Wi-Fi prep
 - Electrical outlets and USB ports in master bedroom
 - Flush floor slides with residential vinyl flooring
 - Glass shower doors
 - Hardwood cabinet doors
 - Hidden hinge cabinet door hinges
 - Kitchen sink covers
 - LED interior lighting
 - Magnetic cabinet door catches
 - Microwave
 - Pressed membrane countertops
 - Rearrange hood vented outside
 - Residential high-rise faucet
 - Robot blackout night shades
 - Stainless steel single basin under-mount kitchen sink
- CUSTOMER CONVENIENCE PACKAGE (Mandatory)**
- 3-burner range with 17" oven and flush mount glass cover
 - 72" x 80" residential style king bed
 - Keycode Alarm™ entry and baggage doors
 - Molded front cap with LED lighting and storage guard protection
 - Pop up wireless and USB charger in bedroom
 - Smart Entertainment HDTV with BlueTooth® Soundbar and built in Stereo
 - TravelD,9000 - Smart RV system that allows for Bluetooth® control of awnings, lighting, slideouts, heating, cooling and more

Base price	58,832.00
USA STANDARDS	n/c
CUSTOMER CONVENIENCE PACKAGE	4,875.00
XTEND SOLAR I PACKAGE	n/c
2ND AC	1,043.00
STABILIZER JACKS	893.00
THEATER SEATS W/TABLE	
TRAY	n/c
DINETTE	n/c
TRI-FOLD SOFA	n/c

UNIT TOTAL 65,643.00

DEALER INSTALLED OPTIONS

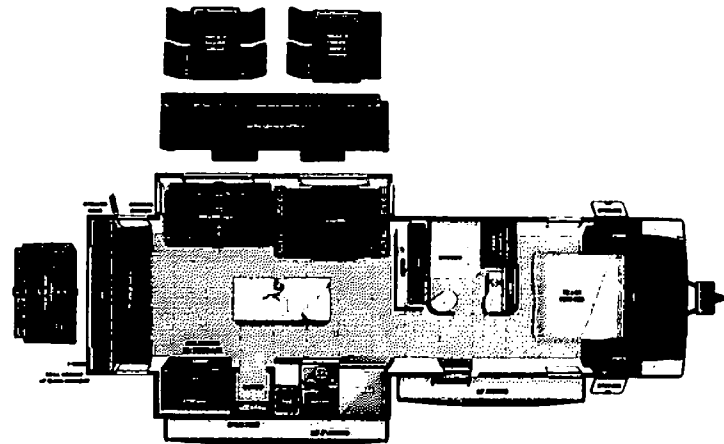

UVW
7589 lbs



Sleeps



Length
33' 10.88"

DIMENSIONS

Exterior height: 134.38"
Exterior width: 96.63"

WEIGHTS

GVWR: 8995
GAWR (front): 4400
GAWR (rear): 4400
Approx. Gross Cargo Carrying Capacity (GCCC): 1406

TIRES

Tire size (front): ST225/75R15E
Tire size (mid):
Tire size (rear): ST225/75R15E

CAPACITIES

Fresh water tank (gals.): 45.00
Gray water tank (gals.): 58.00
Black water/toilet tank (gals.): 29.00
Propane (lbs.): 60
Propane (gals.): 14
Water heater (gals.): 6.00

SEATING & SLEEPING

Some dimensions may be rounded and may vary from the actual dimensions
Weights may be estimated calculations and may vary from the actual weight - refer to the vehicle weight labels for actual weights
Floorplans, features and specifications are subject to change without notice.

