



Highland RIDGE RV

Open Range Roamer



Serial #: 58TCM0BU7S3JC3059
Model: 354MBH OPEN RANGE ROAMER FW

Model Year: 2025 Dealer Name: BERRYLAND CAMPERS
42775 PLEASANT RIDGE ROAD
PONCHATOULA, LA 70454
USA

Manufacturer's Suggested Retail Price **\$93,422.00**

Standard Equipment

- EXTERIOR**
- 100" wide body frame
 - 2" recessed hatch
 - 3-20 lb. LP bottles
 - 50 amp service
 - ACCU-SLIDE™ slide system (42" deep 4 corner compression)
 - Battery disconnect switch
 - Brass hanger bushings with wet bolts
 - Equal-izer® axle suspension
 - Exterior grill/propane quick connect port
 - Laminated black foam door
 - LevelLoc™ - 4 point automatic leveling with JT's Strong Arms®
 - PVC roofing membrane (limited lifetime warranty)
 - Rear roof access ladder
 - Self-adjusting electric brakes
 - Spare tire
 - TuffShell™ - vacuum bonded laminated construction, reinforced with heavy-duty fiberglass and welded aluminum frames
 - XTend Solar I Package (1-200 watt solar panel with 30 amp controller)
- FOUR SEASON PACKAGE (Mandatory)**
- Double insulated baggage doors
 - Ducted heat to underbelly with cold air return
 - Enclosed cable operated gate valves
 - Enclosed exterior docking station with black tank flush
 - Heated and enclosed underbelly
 - High performance furnace
 - R-33 reflective foil insulation in ceiling and underbelly
 - R-9 black foam insulation in sidewalls

- INTERIOR**
- 17 cu. ft. 12V refrigerator
 - 60" x 80" residential queen bed with adjustable power base
 - 75 lb. best bearing drawer guides
 - Cable and satellite prep
 - Flush floor slides with residential vinyl flooring
 - Glass Resistant Shower Door
 - Hardwood cabinet doors
 - Hardwood sidout fascia
 - Large oven and 3-burner range with flush mount glass cover
 - LED interior lighting
 - Observation camera prep
 - Pet/Child Screen Guard on Screen Door
 - Residential microwave
 - Robot blackout night shades
 - Theater seating with power recline
 - Wall controlled power vent (kitchen/living room area)
 - Washer/dryer prep
- EXECUTIVE PACKAGE (Mandatory)**
- 15,000 BTU roof mounted A/C
 - Cutting board and sink strainer
 - Dome style digital TV antenna with Wi-Fi prep
 - Interior convenience center light
 - Keyed-Alike® entry and baggage doors
 - Painted fiberglass front cap with LED lighting and automotive tinted window
 - Power awning with LED lighting
 - Quick recovery gas/electric water heater
 - Quick release fresh water drain
 - Residential high-rise faucet with pull-down sprayer
 - Single basin stainless steel under-mount kitchen sink
 - Smart Entertainment HD TV with Bluetooth®, Soundbar and built in Stereo
 - Solid swing-down entry steps
 - Solid surface kitchen countertops
 - Stainless steel appliances
 - TravelINK® - Smart RV system that allows for Bluetooth® control of awnings, lighting, slides/outs, heating, cooling and more
 - USB/12V charging port

Optional Equipment

- Base price 83,993.00
- USA STANDARDS n/c
 - EXECUTIVE PACKAGE 6,000.00
 - FOUR SEASONS PROTECTION PACKAGE 750.00
 - XTEND SOLAR II PACKAGE 1,343.00
 - 2ND AC 15K BTU DUCTED MAIN BEDROOM 1,043.00
 - POWER FAN VENT BATHROOM n/c
 - ON DEMAND HOT WATER HEATER 293.00
 - NO GENERATOR PREP n/c
 - NO BEDROOM TV n/c
 - WINDOWS STANDARD n/c
 - DINETTE BUNK ROOM n/c

UNIT TOTAL **93,422.00**

DEALER INSTALLED OPTIONS:

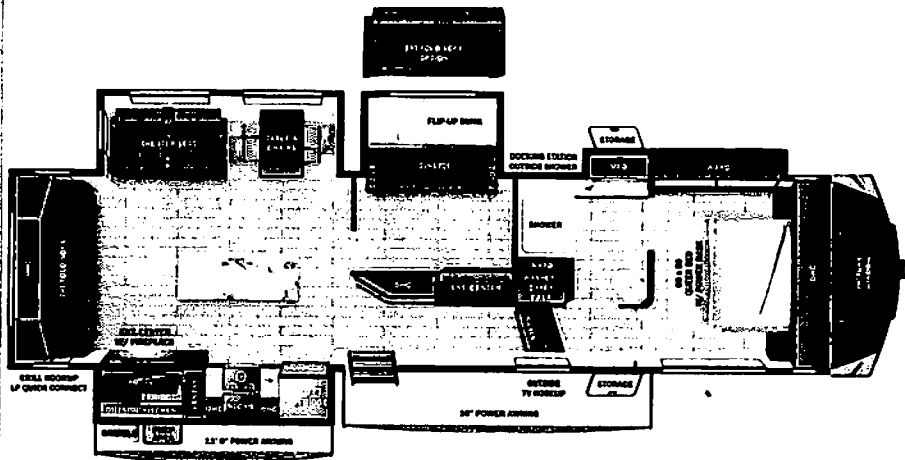

UVW
11594 lbs

Sleeps
3

Length
38' 11.75"

DIMENSIONS

- Exterior height: 159.25"
 - Exterior width: 100.00"
- WEIGHTS**
- GVWR: 13500
 - GAWR (front): 6000
 - GAWR (rear): 6000
 - Approx. Gross Cargo Carrying Capacity (GCC): 1906
- TIRES**
- Tire size (front): ST235/80R16R
 - Tire size (mid):
 - Tire size (rear): ST235/80R16R

CAPACITIES

- Fresh water tank (gals.): 75.00
- Gray water tank (gals.): 97.00
- Black water/toilet tank (gals.): 40.00
- Propane (lbs.): 60
- Propane (gals.): 14
- Water heater (gals.): 6.00

SEATING & SLEEPING

Some dimensions may be rounded and may vary from the actual dimensions
Weights may be estimated calculations and may vary from the actual weight - refer to the vehicle weight labels for actual weights
Floorplans, features and specifications are subject to change without notice.

