

2023 Tiffin Wayfarer 24TW

Stock # T199243

# Pre-owned Motorhome Data Sheet

**Classification:** Class A \_\_\_\_\_ Class B+  Class C \_\_\_\_\_

**Powertrain:** Gasoline \_\_\_\_\_ Diesel

**Horsepower:** 300 \_\_\_\_\_ 340 \_\_\_\_\_ 350 \_\_\_\_\_ 360 \_\_\_\_\_ 380 \_\_\_\_\_ 400 \_\_\_\_\_  
450 \_\_\_\_\_ 500 \_\_\_\_\_ 600 \_\_\_\_\_ 625 \_\_\_\_\_ Other

**Chassis:** Ford \_\_\_\_\_ Chevy \_\_\_\_\_ Workhorse \_\_\_\_\_ Dodge \_\_\_\_\_ Mercedes   
Spartan \_\_\_\_\_ Freightliner \_\_\_\_\_ Powerglide \_\_\_\_\_ Roadmaster \_\_\_\_\_ Other \_\_\_\_\_

**Generator Brand:** Onan  Generac \_\_\_\_\_ Powertec \_\_\_\_\_

**Generator KW Size:** 4K \_\_\_\_\_ 5.5K \_\_\_\_\_ 6K \_\_\_\_\_ 7.5K \_\_\_\_\_ 8K \_\_\_\_\_ 10K \_\_\_\_\_  
12.5K \_\_\_\_\_ Other \_\_\_\_\_

**House Amperage:** 30 Amp  50 Amp \_\_\_\_\_

**Jacks:** Yes  No \_\_\_\_\_ **Auto-leveling:** Yes  No \_\_\_\_\_

**Satellite:** In-motion  Stationary \_\_\_\_\_ None \_\_\_\_\_

**Washer/Dryer:** Stackable \_\_\_\_\_ Combination \_\_\_\_\_ None

**Outside Entertainment:** Yes \_\_\_\_\_ No

**Sleeping Options:** King \_\_\_\_\_ Queen \_\_\_\_\_ Bunks \_\_\_\_\_ Overhead \_\_\_\_\_

**Inverter:** Yes  No \_\_\_\_\_

TWIN BED MODEL

**A/C's:** 1  2 \_\_\_\_\_ 3 \_\_\_\_\_

**Heat Pump:** Yes  No \_\_\_\_\_

**Bathroom Options:** Single  Bath and a half \_\_\_\_\_ 2 Baths \_\_\_\_\_

Stock # T199243

Salesman: Jock Milton

2023 / Tiffin-Wayfarer / 25TW

w/ 5,297 MILES

## 2023 Tiffin Wayfarer 25 TW - Fact Sheet

Mercedes Chassis VIN: W1X8E33Y7NN199243

Tiffin Wayfarer Serial No: 25TW0134263230505

### Factory Installed Upgrades: \*

- Wi-Fi Range Extender
- Cellular Signal Booster
- In-Motion Satellite Dish
- 200-Watt Solar Panel with 30-Amp Controller
- Trauma AquaGo Comfort Plus Instant Water Heater

### Owner Installed Upgrades/Add-Ons: \*

- Haloview BThandy7 Wireless Realtime Rear View Camera & Dash Monitor
- GUTA Tire Pressure Monitoring System (10 sensors)
- Hellwig Rear Sway Bar
- Agile Fox 2.5 Rear Shocks
- RV Airflow Systems Efficiency Duct Kit
- Tentproinc RV Awning Sun Shade (8'x14')
- Smartliner Custom Fit Floor Mats
- Losrik RV Power Vent Insulators (3)
- Progressive Industries RV Surge Protector 30 Amp with Electrical Management System, EMS-PT30X
- Agile Off Road Chassis Dual-Horn
- Custom Window Tinting (driver/passenger chassis windows)
- Quest Overland Insulated Windshield/Cabin Door Window Shades
- Custom Stainless Steel Tailpipe
- SnapPad Hydraulic Leveling Jack Pads

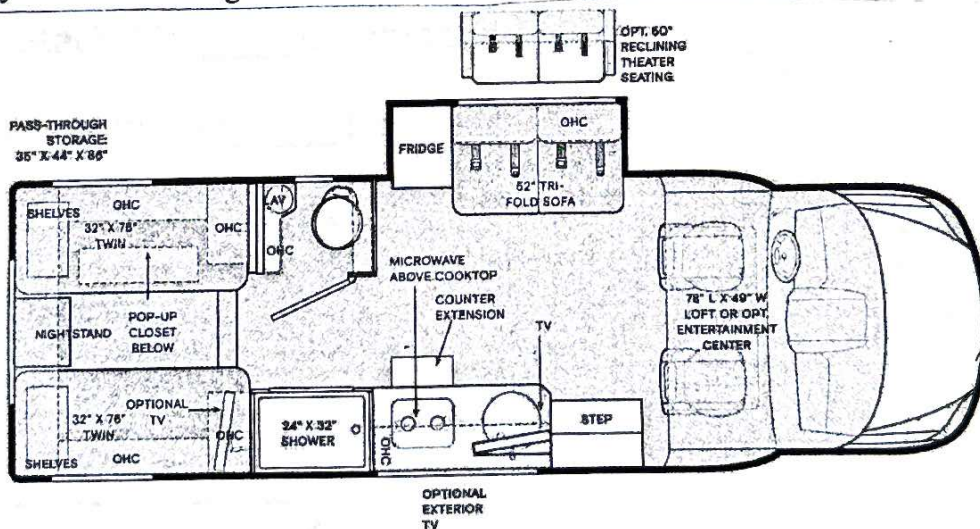

Jock Milton

985-351-0885 Cell

1-877-370-7001 Store