



Highland RIDGE RV

Range Lite



Serial #: 58TBH0BK4N3EB3099
Model: 212FB RANGE LITE TT

Model Year: 2022 Dealer Name: BERRYLAND CAMPERS
42775 PLEASANT RIDGE ROAD
PONCHATOULA, LA 70454
USA

Standard Equipment

THE FOLLOWING ITEMS ARE STANDARD ON THIS MODEL
AT NO EXTRA CHARGE

Optional Equipment

OPTIONAL EQUIPMENT INSTALLED ON THIS VEHICLE
BY MANUFACTURER

- | | |
|--|---|
| <p>EXTERIOR</p> <ul style="list-style-type: none"> - 5/8" main floor decking - Door side spray port - Exterior grill hookup quick connect port - Flexible LP lines - Fully-walkable roof - In-frame battery rack - Magnetic baggage door catches - Marine grade exterior speakers (2) - Oversized pass-through storage with motion lighting - PVC roofing membrane (lifetime limited warranty) - Rain gutters with molded drip spouts - Safety bumper with drain hose carrier and end caps - Self-adjusting electric brakes - Side camera prep marker lights - Solid swing down entry steps - Thermal Seal - enclosed, insulated, and heated underbelly and fully insulated roof with a PVC roofing membrane - Tinted safety-glass windows throughout - TuffShell™ - vacuum bonded laminated construction, reinforced with heavy-duty fiberglass and welded aluminum frames | <p>INTERIOR</p> <ul style="list-style-type: none"> - 60" X 80" queen bed with storage drawers below - 75 lb. ball bearing drawer guides - 81" interior height - Cable and satellite prep - Electrical outlets and USB ports in master bedroom - Flush floor slides with residential vinyl flooring - Hardwood cabinet doors - Kid and pet friendly - residential vinyl flooring throughout, vinyl furniture, no floor heat registers - Kitchen sink covers - Laundry chute in bedroom - LED interior lighting - Porcelain foot flush toilet - Range hood - Residential high-rise faucet with pull-down sprayer - Roller blackout night shades - Single basin stainless steel under-mount kitchen sink - Tri-fold sofa <p>CUSTOMER CONVENIENCE PACKAGE (MANDATORY)</p> <ul style="list-style-type: none"> - 15,000 BTU roof mounted A/C - 2-30 lb. LP bottles with cover - 3-burner range with 17" oven with LED lighting and flush mount glass cover - 8 cu. ft. refrigerator - AM/FM/HDMI/USB/AUX Bluetooth® sound bar stereo with indoor/outdoor zoned speakers - Bathroom skylight and roof vent - Bedspread - Dome style TV antennae with Wi-Fi prep - Enclosed exterior docking station with black tank flush - Entrance door with screen door, window and magnet door catch - EZ-store detachable cord - Fiberglass front cap with LED lighting and stoneguard protection - Foldable grab handle - Gas/electric DSI water heater - LED HDTV - Medicine cabinet - Microwave - Nitrogen filled radial tires with aluminum Rims - Porcelain foot flush toilet - Power awning with LED lighting - Power tongue jack - Powered 12V bathroom vent - Pressed membrane countertops - Rear observation camera prep - Rear roof access ladder |
|--|---|

| | |
|------------------------------|-----------|
| Base price | 32,760.00 |
| USA Standards | n/c |
| Customer Convenience Package | 4,500.00 |
| No Solar Package | n/c |
| Manual Stab Jacks | n/c |

UNIT TOTAL **37,260.00**

DEALER INSTALLED OPTIONS

Manufacturer's Suggested Retail Price \$37,260.00

TOTAL AMOUNT DOES NOT INCLUDE STATE AND LOCAL TAXES OR LICENSE FEES. THE PRICE SHOWN ABOVE MAY OR MAY NOT BE REPRESENTATIVE OF THE ACTUAL SELLING PRICE OF SIMILAR RECREATIONAL VEHICLES IN YOUR AREA.

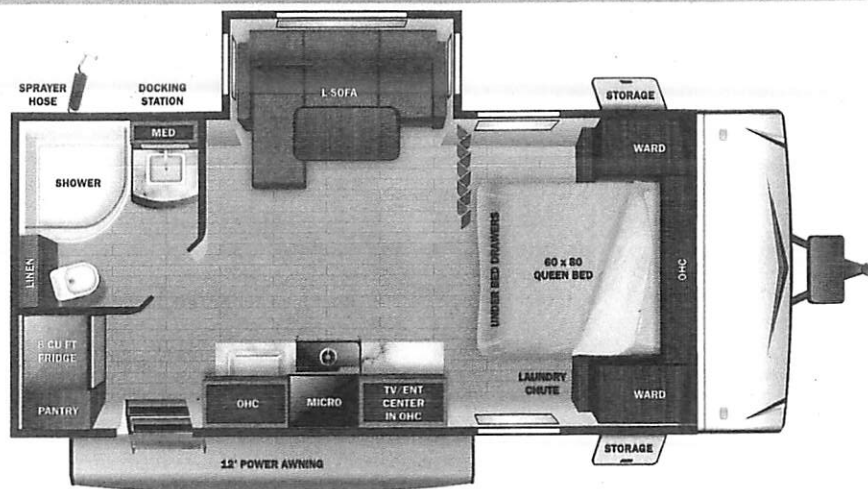

UVW
4930 lbs

Sleeps

Length
23' 8"

DIMENSIONS

| | |
|------------------|---------|
| Exterior height: | 132.88" |
| Exterior width: | 96.75" |

WEIGHTS

| | |
|---------------|------|
| GVWR: | 6400 |
| GAWR (front): | 3500 |
| GAWR (rear): | 3500 |

| | |
|---|------|
| Approx. Gross Cargo Carrying Capacity (GCCC): | 1470 |
|---|------|

TIRES

| | |
|--------------------|--------------|
| Tire size (front): | ST205/75R14D |
| Tire size (mid): | |
| Tire size (rear): | ST205/75R14D |

CAPACITIES

| | |
|----------------------------------|-------|
| Fresh water tank (gals.): | 45.00 |
| Gray water tank (gals.): | 29.00 |
| Black water/toilet tank (gals.): | 29.00 |
| Propane (lbs.): | 60 |
| Propane (gals.): | 14 |
| Water heater (gals.): | 6.00 |

SEATING & SLEEPING

| | |
|------------|---------|
| Queen Bed: | 60 X 80 |
|------------|---------|

Some dimensions may be rounded and may vary from the actual dimensions

Weights may be estimated calculations and may vary from the actual weight - refer to the vehicle weight labels for actual weights

Floorplans, features and specifications are subject to change without notice.

