

OPEN RANGE

MSRP PRICE SHEET

2009 Fifth Wheel
391RES
Effective Date: 7/01/2008

Dealer Name: BERRYLAND CAMPERS
VIN # 5XMF382295000637

DÉCOR OPTIONS:

- ☐ Haversham (Blue/Brown)
☐ Lifelong (Green)
☒ Sheridan (Neutral/Tan)

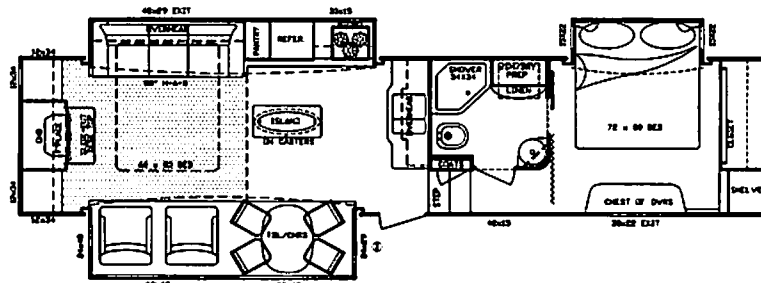

391 RES

OPTIONAL FEATURES

| | Price | Description |
|-------------------------------------|---------|---|
| <input checked="" type="checkbox"/> | \$413 | Wire and Frame for 2nd A/C (Mandatory) (Includes 50 Amp Service) |
| <input checked="" type="checkbox"/> | \$770 | 2nd A/C 15,000 BTU, Ducted |
| | \$1,113 | Dual Pane Windows |
| | \$693 | Generator Prep (Grill n/a w/Gen. Prep.) |
| <input checked="" type="checkbox"/> | \$413 | 16" Aluminum Wheels & Tires (Mandatory) |
| <input checked="" type="checkbox"/> | \$308 | Power Rear Stabilizer Jacks |
| <input checked="" type="checkbox"/> | \$140 | Rear Ladder |
| | \$350 | Additional Fantastic Fan in Bedroom |
| <input checked="" type="checkbox"/> | \$693 | Fireplace (337, 385, 391 only) |
| <input checked="" type="checkbox"/> | \$413 | Central Vacuum |

| | Price | Description |
|-------------------------------------|---------|---|
| <input checked="" type="checkbox"/> | \$273 | Dual LP with Slide Trays (80lb capacity) |
| <input checked="" type="checkbox"/> | \$700 | Four Seasons Protection Package (Mandatory) |
| <input checked="" type="checkbox"/> | \$2,100 | Entertainment Package (Mandatory) |
| <input checked="" type="checkbox"/> | \$3,500 | Executive Living Package (Mandatory) |
| <input checked="" type="checkbox"/> | \$91 | RVIA |
| | \$273 | Q.A.I. Construction (Canadian Dealers ONLY) |
| | \$91 | Go RVing MEP Fee (Canada) |
| | | |
| | | |
| | | |
| | | |

Four Seasons Protection Package: Atwood High Performance Furnace, Double Insulated Baggage Doors, Heated Storage Area, Heated Underbelly, Insulated Slide-Floor, Heated & Enclosed Dump Valves, Vented Attic, Remote Digital Thermostat, R-9 Walls, R-21 Floor, up to R-28 Ceiling.

Entertainment Package: 42" LCD TV, 19" LCD TV w/Portable Swing Arm, DVD/CD/MP3/AM/FM Player w/Jensen Surround Sound Speaker, Dual Jensen Speaker in Pass-Through Storage Area, TV Antenna and booster.

Executive Living Package: INTERIOR OPTIONS - Large 8 Cubic Ft. Refer, 10 Gal. Quick Recovery Water Heater, 15,000 BTU A/C, Corian Counter Tops in Galley, "Fantastic Fan", Residential Hide-a-bed Sofa, "Posterest" Pillowtop Residential Mattress, Wine Rack, Pull-Out Pantry. EXTERIOR OPTIONS - Power Awning, "MaxxAir" Vent Cover, King-Pin Stabilizer, 16" Aluminum 6-Lug Wheels.

Standard Features: INTERIOR -High Output Range w/ignitor and Large 22" Oven. HUD Approved Luan Wall Board, Maple Hardwood Raised Panel Glazed Cabinet Doors, Full Extension Drawer Guides, Fluorescent Light in Galley, Pull-Out Waste Basket, Portable Laundry Basket, Washer/Dryer Prep, Glass Shower Door & Surround, Sky Light above Shower, Cable Hook-up, Satellite Prep, Glass Vessel Lavatory Bowl Sink with Single Lever Lavatory Faucet, Porcelain Toilet, Motion Detector Night Light. EXTERIOR - Contoured Front Cap for Superior Turning Radius, Exterior Utility Center w/Black Tank Flush, Battery Disconnect, "Dexter" Wide Stance E-Z Lube Axles, Equa Flex Suspension, Radial Tires, Wide Stance Front Electric Jacks, Rear Stabilizer Jacks, Large Triple 9" Entry Steps, Dual Outdoor Security Lights, Extended Gutter Spouts, Large Stainless Steel Assist Grab Handle.

| | |
|------------------|-------------|
| BASE PRICE: | \$46,935.00 |
| OPTIONS: | \$9,814.00 |
| DESTINATION CHG: | \$992.00 |
| FUEL SURCHARGE: | \$679.00 |
| TOTAL: | \$58,420.00 |

*** Prices, features and options are subject to change without notice.

OPEN RANGE RV COMPANY - 3195 N. S.R. 5, SHIPSEWANA, INDIANA 46565 PHONE: (260) 768-7771 FAX (260) 768-7077